



13 Southfield Road, Princes Risborough, HP27 0JD £400,000 *Freehold*

Move Straight In

- Three Bedrooms
- No Upward Chain
- Refurbished Throughout
- Refitted Modern Kitchen
- Separate Breakfast Area
- Contemporary Bathroom & W/C
- Good Size Rear Garden
- New Central Heating System
- Driveway Parking
- Well Placed For Amenities
- EPC: To be confirmed



Exciting news! Recently modernised and refurbished end terrace house, boasting a brand new gas central heating system. Offered for sale with no upward chain, this property features a superb modern kitchen/breakfast room, dual aspect lounge and a stylish bathroom with a separate w/c. Step outside to enjoy the spacious rear garden, perfect for outdoor activities, and benefit from the added convenience of driveway parking. Nestled in an accessible location, this home is close to local amenities, schools, and transport links. Don't miss out on the opportunity to make this stunning property yours.

Southfield Road provides easy walking access to Princes Risborough High Street where comprehensive shopping facilities incorporating Tesco's supermarket, Marks and Spencer food hall, restaurants, pubs and library can be found along with Risborough Springs leisure centre and mainline train station providing access to London Marylebone, Oxford and Aylesbury.

Council Tax Band: D

AML Disclaimer

Please note it is a legal requirement that we require verified ID from purchasers before instructing a sale. Please also note we shall require proof of funds before we instruct the sale, together with your instructed solicitors.

Agents Note

We may refer you to recommended providers of ancillary services such as Conveyancing, Financial Services, Insurance and Surveying. We may receive a commission payment fee or other benefit (known as a referral fee) for recommending their services. You are not under any obligation to use the services of the recommended provider. The ancillary service provider may be an associated company of JNP Estate Agents Ltd.



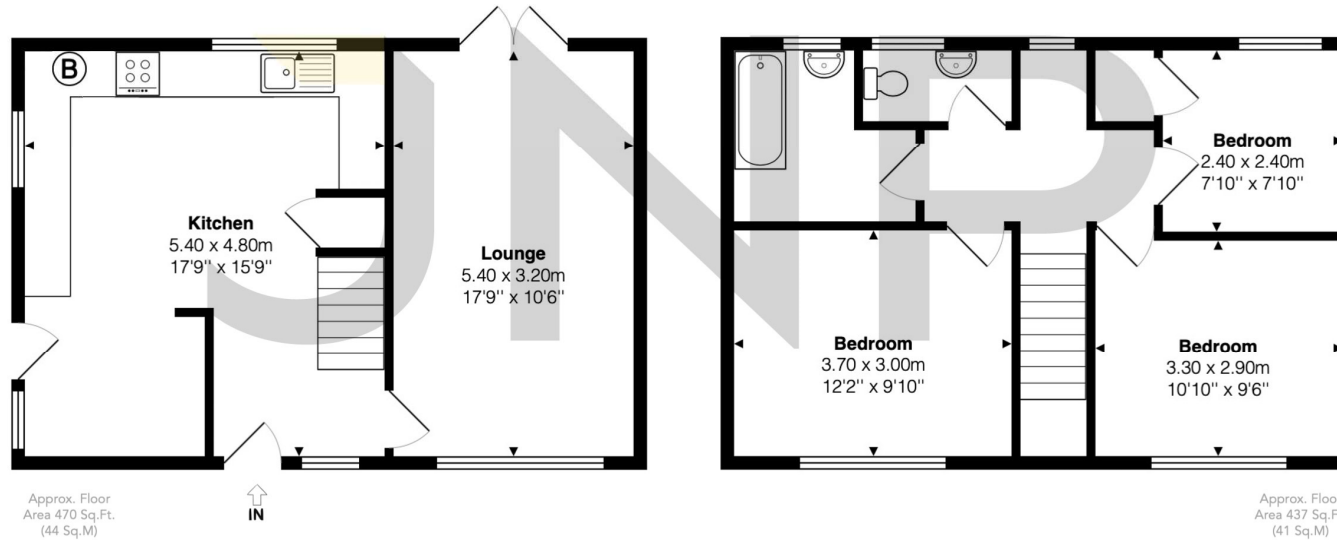

The approximate total area for the elements of the property represented on the floorplan is 84 SqM (907 Sq.Ft)

Southfield Road, Princes Risborough, Buckinghamshire, HP27 0JB

This floor plan is provided by Expert Survey Solutions Ltd for indicative guidance only. Whilst every attempt has been made to ensure the accuracy of the floor plans contained here, measurements of doors, windows and rooms are approximate and no responsibility is taken for any error, omission or mis-statement. Details shown on this floorplan including all measurements, areas and proportions cannot be guaranteed by either the provider or estate agency and should not be relied upon. If there is any area where accuracy is required, please contact the selling agent for clarification.

Princes Risborough (JNP)
01844 345666
riz@jnp.co.uk

1 Market Square
Princes Risborough, Buckinghamshire, HP27
0AP



@JNPestateagents



@jnpestateagents

JNP is a trading name of JNP Estate Agents Ltd registered in England at Howard House, 3 St Mary's Court, Blossom Street, York, YO24 1AH. Company number 03764697. We may refer you to recommended providers of ancillary services such as Conveyancing, Financial Services, Insurance and Surveying. We may receive a commission payment fee or other benefit (known as a referral fee) for recommending their services. You are not under any obligation to use the services of the recommended provider. The ancillary service provider may be an associated company of JNP.