

JNP



23 Windsor Lodge, Wellington Avenue, Princes Risborough, HP27 9EE

OIRO £210,000 *Leasehold*

Fantastic Size Retirement Apartment

- First Floor Apartment
- Lift Access
- Centrally Located Development
- Great Access To Amenities
- Large Lounge/Diner
- One Bedroom
- Communal Lounge
- Shared Residents Parking
- Pleasant Communal Gardens
- No Upward Chain
- EPC: To be confirmed



Don't miss out on the chance to secure possibly the largest one-bedroom apartment in the development! This gem features a generously sized open-plan lounge/dining room, perfect for relaxing evenings or hosting gatherings. The kitchen is fully equipped with fitted appliances, making meal preparation a breeze.

Situated just a short flat walk from the High Street and local amenities, this charming first-floor apartment is a cosy retreat with one spacious bedroom. The well-maintained interiors create a

warm and inviting atmosphere, ensuring you feel right at home from the moment you step inside.

Enjoy the established communal gardens and neighbouring park for leisurely strolls. Shared resident parking provides added convenience for those who still drive. This property offers a peaceful retirement setting without compromising on convenience.

Lease Length: 111 Years remaining
Ground Rent: £589 Per Annum
Service Charge: £2,314 Per Annum

AML Disclaimer

Please note it is a legal requirement that we require verified ID from purchasers before instructing a sale. Please also note we shall require proof of funds before we instruct the sale, together with your instructed solicitors.

Agents Note

We may refer you to recommended providers of ancillary services such as Conveyancing, Financial Services, Insurance and Surveying. We may receive a commission payment fee or other benefit (known as a referral fee) for recommending their services. You are not under any obligation to use the services of the recommended provider. The ancillary service provider may be an associated company of JNP Estate Agents Ltd.



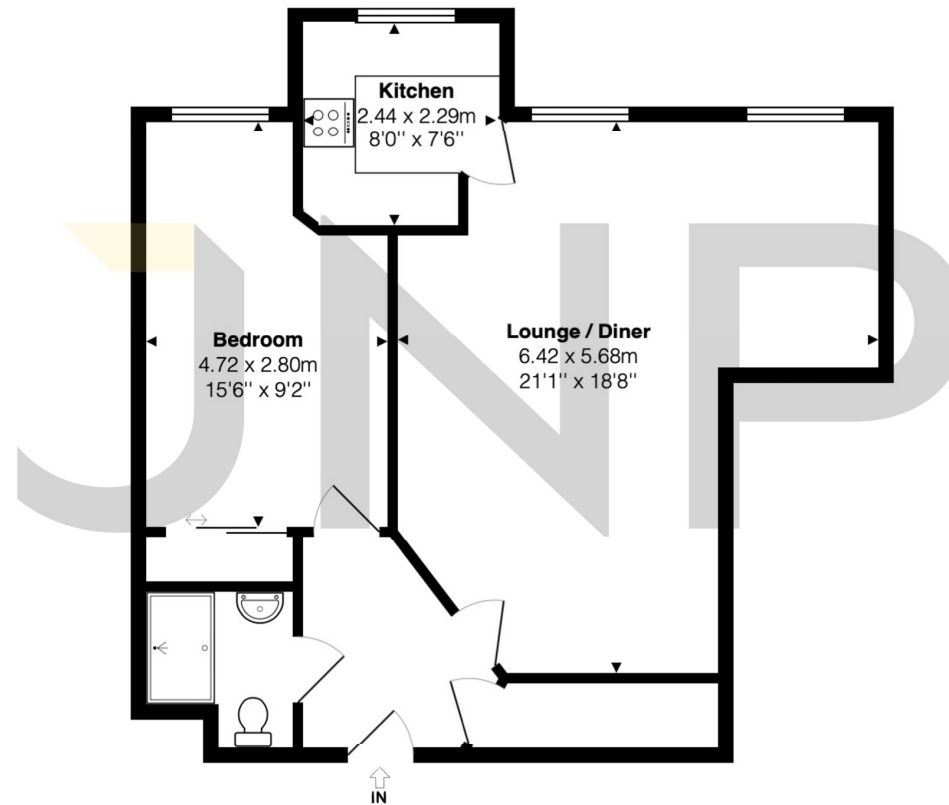

The approximate total area for the elements of the property represented on the floorplan is XX SqM (XXX Sq.Ft)

23 Windsor Lodge, Wellington Avenue, Princes Risborough, Buckinghamshire, HP27 9EE

This floor plan is provided by Expert Survey Solutions Ltd for indicative guidance only. Whilst every attempt has been made to ensure the accuracy of the floor plans contained here, measurements of doors, windows and rooms are approximate and no responsibility is taken for any error, omission or mis-statement. Details shown on this floorplan including all measurements, areas and proportions cannot be guaranteed by either the provider or estate agency and should not be relied upon. If there is any area where accuracy is required, please contact the selling agent for clarification.

Princes Risborough (JNP)
01844 345666
riz@jnp.co.uk

1 Market Square
Princes Risborough, Buckinghamshire, HP27
0AP

 @JNPestateagents  @jnpestateagents

JNP is a trading name of JNP Estate Agents Ltd registered in England at Howard House, 3 St Mary's Court, Blossom Street, York, YO24 1AH. Company number 03764697. We may refer you to recommended providers of ancillary services such as Conveyancing, Financial Services, Insurance and Surveying. We may receive a commission payment fee or other benefit (known as a referral fee) for recommending their services. You are not under any obligation to use the services of the recommended provider. The ancillary service provider may be an associated company of JNP.