



JNP

15 Laceys Drive, Hazlemere, HP15 7JY

£725,000 *Freehold*

A Detached Family Home Offering Superb Living Accommodation

- Three Double Bedrooms
- Study/Guest Bedroom
- Generously Sized Living Accommodation
- Modern Kitchen
- Driveway Parking For Several Cars
- Garage
- Fantastic Size Rear Garden
- Within Easy Reach of Local Schools & Amenities
- Viewing is Highly Recommended
- EPC: D



This attractive detached family home has been altered considerably since it was originally built back in the 1950s and offers fantastic living accommodations. An entrance porch leads through to an entrance hallway with stairs rising to the first floor and doors leading through to a generously sized living room with a deep bay window to the front as well as a recently replaced and remodelled kitchen with a pitched roof with Velux windows. The kitchen leads through to a spacious utility room and further through to a shower room. Accessed from the living room and the kitchen is a formal dining room that leads both to the study/guest bedroom and a lovely conservatory overlooking a beautifully maintained garden.

On the first floor are three double bedrooms with a modern fitted family bathroom.

To the front of the property is a driveway for several cars as well as a garage and lawn garden to the side. To the rear is a fantastic and generously sized rear garden with several flower and shrub borders. Mature trees provide privacy throughout.

The property is located within easy reach of a range of local schools with several local amenities right on hand. An internal inspection of the property is highly recommended to fully appreciate.

Freehold Notes
Council Tax band F. EPC band D.

Agents Note
We may refer you to recommended providers of ancillary services such as Conveyancing, Financial Services, Insurance and Surveying. We may receive a commission payment fee or other benefit (known as a referral fee) for recommending their services. You are not under any obligation to use the services of the recommended provider. The ancillary service provider may be an associated company of JNP Estate Agents Ltd.



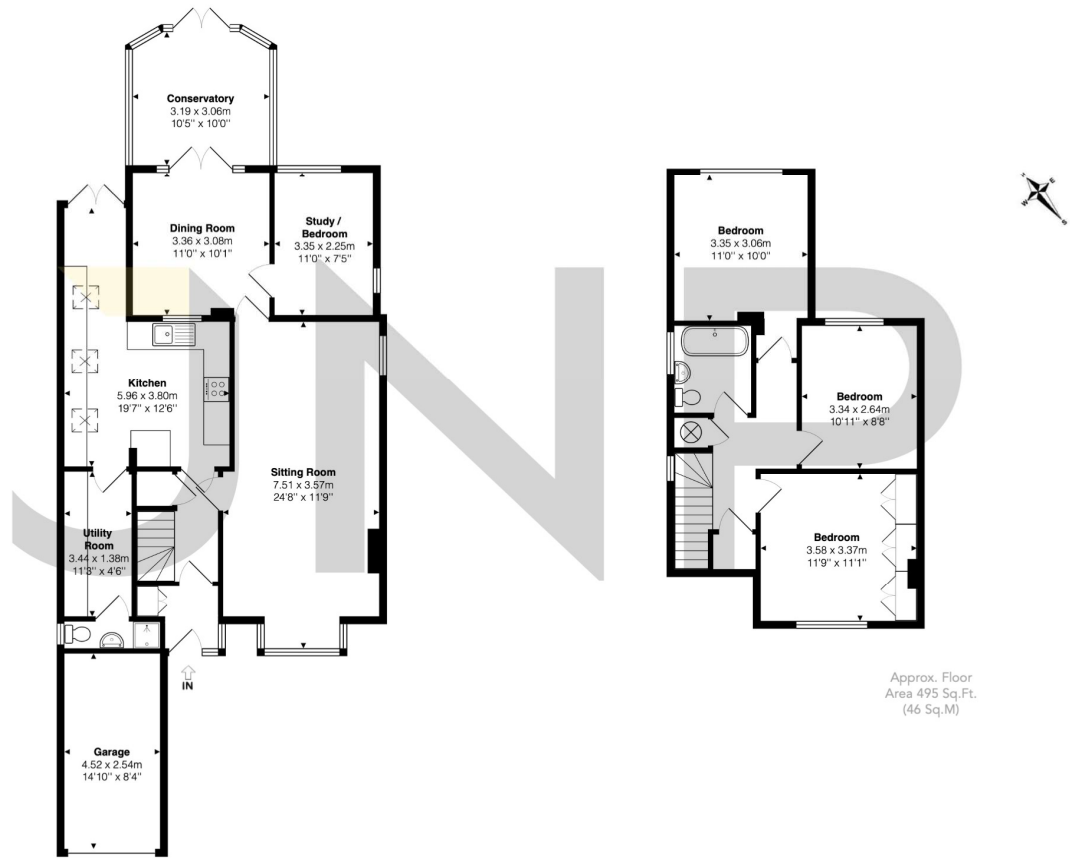

Approx. Floor Area 1035 Sq.Ft. (96 Sq.M)

Approx. Floor Area 495 Sq.Ft. (46 Sq.M)

The approximate total area for the elements of the property represented on the floorplan is 142 SqM (1529 Sq.Ft)

Laceys Drive, Hazlemere, Buckinghamshire, HP15 7JY

This floor plan is provided by Expert Survey Solutions Ltd for indicative guidance only. Whilst every attempt has been made to ensure the accuracy of the floor plans contained here, measurements of doors, windows and rooms are approximate and no responsibility is taken for any error, omission or mis-statement. Details shown on this floorplan including all measurements, areas and proportions cannot be guaranteed by either the provider or estate agency and should not be relied upon. If there is any area where accuracy is required, please contact the selling agent for clarification.

Hazlemere and Great Missenden
01494 716000
haz@jnp.co.uk

330 Amersham Road
Hazlemere, High Wycombe, HP15 7PU

@JNPestateagents @jnpestateagents

JNP is a trading name of JNP Estate Agents Ltd registered in England at Howard House, 3 St Mary's Court, Blossom Street, York, YO24 1AH. Company number 03764697. We may refer you to recommended providers of ancillary services such as Conveyancing, Financial Services, Insurance and Surveying. We may receive a commission payment fee or other benefit (known as a referral fee) for recommending their services. You are not under any obligation to use the services of the recommended provider. The ancillary service provider may be an associated company of JNP.