

The logo consists of the letters 'JNP' in a bold, black, sans-serif font, centered within a bright yellow rectangular background.

Totteridge Road, High Wycombe, HP13

£1,700 per month

3 Bedroom Detached Family Home

- 3 Total Bedrooms
- 2 Reception Rooms
- 2 Bathrooms
- House
- Detached
- Garden

EPC EER Rating D: A fantastic 3-bedroom family home, located within easy reach of High Wycombe town centre & train station. Recently refurbished throughout, the accommodation in brief comprises of, spacious lounge & separate dining room. Fitted kitchen with access to rear garden. Separate utility area & guest cloakroom. Upstairs there are 3 double bedrooms, with main bathroom with shower cubical. Outside to the rear, there is a large, raised patio leading to spacious lawn. Parking for 4 cars can be found at the front via shared driveway. Available Now on an unfurnished basis. Council Tax Band E.

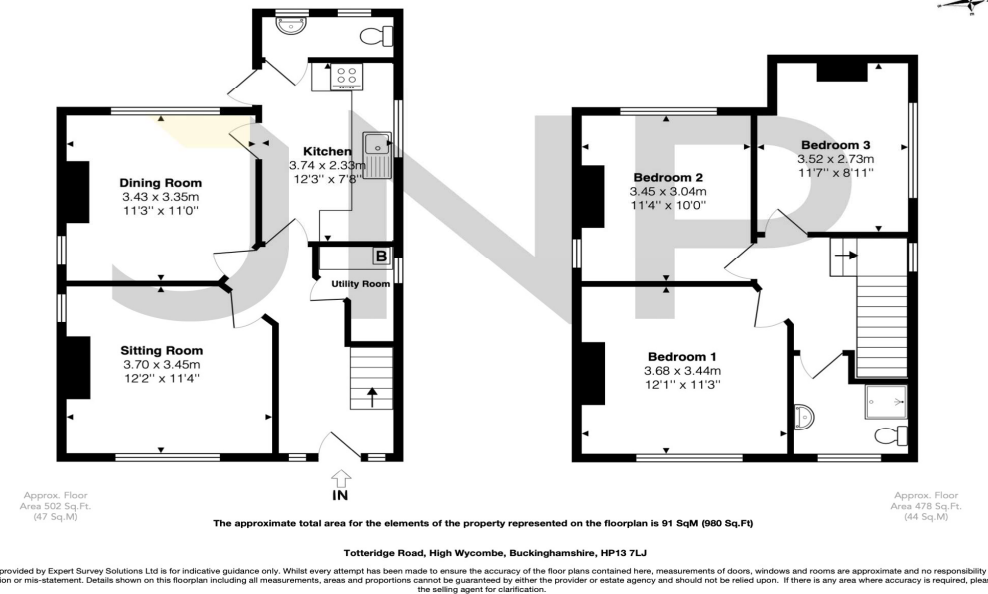

We may refer you to recommended providers of ancillary services such as Conveyancing, Financial Services, Insurance and Surveying. We may receive a commission payment fee or other benefit (known as a referral fee) for recommending their services. You are not under any obligation to use the services of the recommended provider. The ancillary service provider may be an associated company of JNP Lettings

We can be contacted on; 01494 725 656 or Amershamlettings@jnp.co.uk

